



Angle Grinder

Slide switch: GA003G / GA004G / GA005G / GA006G / GA007G / GA008G

Paddle switch: GA011G / GA012G / GA013G / GA014G / GA015G / GA016G

100 mm (4") 115 mm (4-1/2") 125 mm (5") 100 mm (4") 115 mm (4-1/2") 125 mm (5")

Delivers same power as 1,000W corded grinders

High durability

- Large ball bearing supports the motor.
- New switch design to reduce contact weariness.

No load speed:

8,500 min.⁻¹

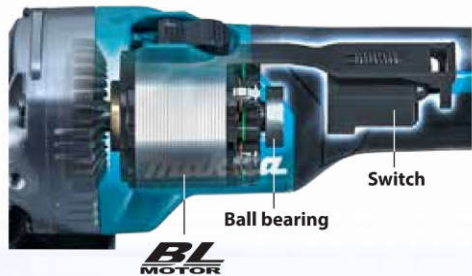

AFT Active Feedback sensing Technology

Shuts down the tool to protect the user, if the rotation speed suddenly slows down.

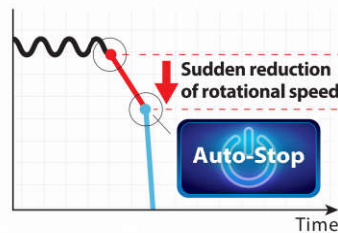

New toolless wheel cover

allows for fast and easy angle adjustment and installation / removal of wheel cover.

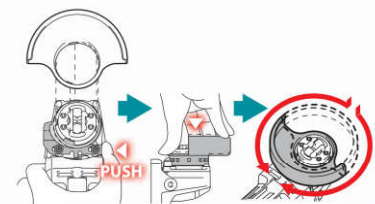

about
**40%
UP**

Cut concrete at depths of 20mm

GA005G **140**

18V Predecessor Model **100**

Slow

Fast

Work amount on a full battery charge^{*1}

Battery: BL4040

about **7 m**

Cutting depths: 20mm

Accessories

Dust collection wheel guard

191F81-2

191G06-2





BL MOTOR **AFT** **XPT** **(BRAKE)**

GA003G / GA004G / GA005G / GA011G / GA012G / GA013G

Slide Switch

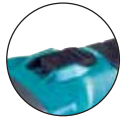

GA005G

Paddle Switch



GA013G

Easy-to-hold slim grip

	GA003G	GA004G	GA005G	GA006G	GA007G	GA008G
Wheel Diameter	100 mm (4")	115 mm (4-1/2")	125 mm (5")	100 mm (4")	115 mm (4-1/2")	125 mm (5")
Hole Diameter	16 mm (5/8")	22.23 mm (7/8")	22.23 mm (7/8")	16 mm (5/8")	22.23 mm (7/8")	22.23 mm (7/8")
No Load Speed (RPM)	8,500	8,500	8,500	8,500	8,500	8,500
Sound Pressure Level	81 dB(A)	81 dB(A)	81 dB(A)	81 dB(A)	81 dB(A)	81 dB(A)
Sound Power Level	92 dB(A)	92 dB(A)	92 dB(A)	92 dB(A)	92 dB(A)	92 dB(A)
Dimensions (L x W x H)	w/ BL4025: 398x117x150 mm (15-5/8"x4-5/8"x5-7/8")	w/ BL4025: 398x130x156 mm (15-5/8"x5-1/8"x6-1/8")	w/ BL4025: 398x140x156 mm (15-5/8"x5-1/2"x6-1/8")	w/ BL4025: 398x117x146 mm (15-5/8"x4-5/8"x5-3/4")	w/ BL4025: 398x130x152 mm (15-5/8"x5-1/8"x6")	w/ BL4025: 398x140x152 mm (15-5/8"x5-1/2"x6")
	w/ BL4040: 410x117x162 mm (16-1/8"x4-5/8"x6-3/8")	w/ BL4040: 410x130x168 mm (16-1/8"x5-1/8"x6-5/8")	w/ BL4040: 410x140x168 mm (16-1/8"x5-1/2"x6-5/8")	w/ BL4040: 410x117x158 mm (16-1/8"x4-5/8"x6-1/4")	w/ BL4040: 410x130x165 mm (16-1/8"x5-1/8"x6-1/2")	w/ BL4040: 410x140x165 mm (16-1/8"x5-1/2"x6-1/2")
Net weight	2.8 - 3.3 kg (6.2 - 7.3 lbs.)	2.9 - 3.5 kg (6.4 - 7.7 lbs.)	2.9 - 3.6 kg (6.4 - 7.9 lbs.)	2.7 - 3.3 kg (6.0 - 7.3 lbs.)	2.9 - 3.5 kg (6.4 - 7.7 lbs.)	2.9 - 3.5 kg (6.4 - 7.7 lbs.)
	GA011G	GA012G	GA013G	GA014G	GA015G	GA016G
Wheel Diameter	100 mm (4")	115 mm (4-1/2")	125 mm (5")	100 mm (4")	115 mm (4-1/2")	125 mm (5")
Hole Diameter	16 mm (5/8")	22.23 mm (7/8")	22.23 mm (7/8")	16 mm (5/8")	22.23 mm (7/8")	22.23 mm (7/8")
No Load Speed (RPM)	8,500	8,500	8,500	8,500	8,500	8,500
Sound Pressure Level	81 dB(A)	81 dB(A)	81 dB(A)	81 dB(A)	81 dB(A)	81 dB(A)
Sound Power Level	92 dB(A)	92 dB(A)	92 dB(A)	92 dB(A)	92 dB(A)	92 dB(A)
Dimensions (L x W x H)	w/ BL4025: 398x117x150 mm (15-5/8"x4-5/8"x5-7/8")	w/ BL4025: 398x130x156 mm (15-5/8"x5-1/8"x6-1/8")	w/ BL4025: 398x140x156 mm (15-5/8"x5-1/2"x6-1/8")	w/ BL4025: 398x117x146 mm (15-5/8"x4-5/8"x5-3/4")	w/ BL4025: 398x130x152 mm (15-5/8"x5-1/8"x6")	w/ BL4025: 398x140x152 mm (15-5/8"x5-1/2"x6")
	w/ BL4040: 410x117x162 mm (16-1/8"x4-5/8"x6-3/8")	w/ BL4040: 410x130x168 mm (16-1/8"x5-1/8"x6-5/8")	w/ BL4040: 410x140x168 mm (16-1/8"x5-1/2"x6-5/8")	w/ BL4040: 410x117x158 mm (16-1/8"x4-5/8"x6-1/4")	w/ BL4040: 410x130x165 mm (16-1/8"x5-1/8"x6-1/2")	w/ BL4040: 410x140x165 mm (16-1/8"x5-1/2"x6-1/2")
Net weight	2.8 - 3.4 kg (6.2 - 7.5 lbs.)	3.0 - 3.6 kg (6.6 - 7.9 lbs.)	3.0 - 3.6 kg (6.6 - 7.9 lbs.)	2.8 - 3.3 kg (6.2 - 7.3 lbs.)	2.9 - 3.5 kg (6.4 - 7.7 lbs.)	2.9 - 3.5 kg (6.4 - 7.9 lbs.)

	Wheel Diameter	Switch	(BRAKE)
GA003G	100 mm (4")	Slide	✓
GA004G	115 mm (4-1/2")		
GA005G	125 mm (5")		
GA006G	100 mm (4")		
GA007G	115 mm (4-1/2")		
GA008G	125 mm (5")	Paddle	✓
GA011G	100 mm (4")		
GA012G	115 mm (4-1/2")		
GA013G	125 mm (5")		
GA014G	100 mm (4")		
GA015G	115 mm (4-1/2")		
GA016G	125 mm (5")		

*1 The test results depend to a great extent on the test material etc. 13