



KONICA MINOLTA

# COLOR READER CR-10 Plus

**Simple operation shows the color difference between your target and samples in an instant.**

**Simple basic operation. Just three steps:**  
Switch on → Measure target → Measure samples

**Lightweight and compact!**

**Large easy-to-read display!**

Konica Minolta's  
new Color Reader Series  
has arrived!



## ■ Useful functions available with PC application

The PC application stored in the CR-10 Plus body helps you manage data more effectively. (Note: PC is required to use PC application.)

### 1 Measurement data can be stored in the CR-10 Plus

The CR-10 Plus can be set to store measurement data (up to 1,000 measurement data including target data) in its memory. (Once this setting has been made, it is not necessary to use the PC application to set it again.)

### 2 Pass/fail judgment

You can set a tolerance on the CR-10 Plus. Then, if the color difference exceeds the tolerance, the CR-10 Plus warns you that the sample exceeds tolerance by highlighting the over-tolerance value in the display and giving a different sound than for measurements that pass, so you can know immediately whether the sample color has passed or failed. (Once this setting has been made, it is not necessary to use the PC application to set it again.)

### 3 Small Aperture Measurement Set (Optional accessory)

A  $\phi 5$  mm target mask is also available. It includes a Target Guide for positioning the instrument for measurements.

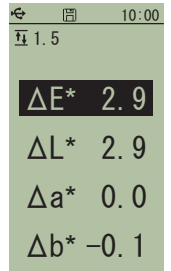

Display example

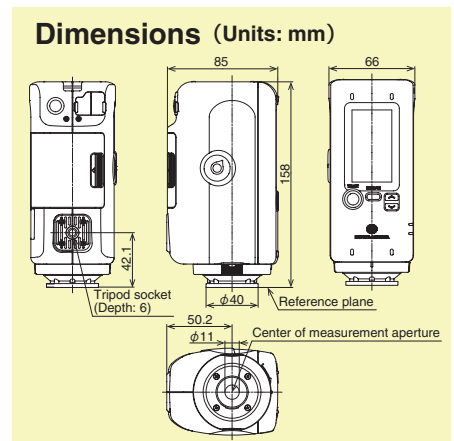
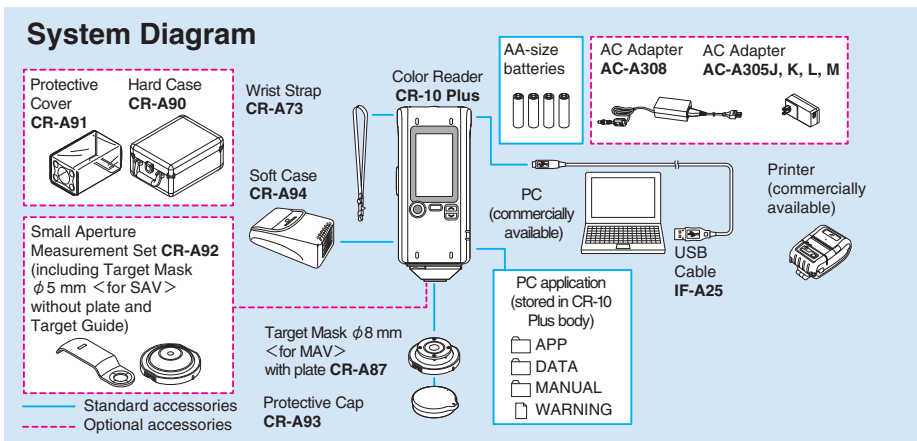

## Main Specifications

Model	Color Reader CR-10 Plus
Illumination/viewing system	8°:di (8°illumination angle/diffuse viewing: specular component included) (conforms to DIN 5033 Teil 7, JIS Z 8722 condition d, ISO 7724/1, CIE No. 15, ASTM E 1164)
Detector	Silicon photocells (6 pcs.)
Display range	L*: 1 to 100
Light source	Pulsed xenon lamps
Measurement time	Approx. 1 sec.
Battery performance	Approx. 2,000 measurement at 10-sec. intervals when using alkaline-manganese batteries
Measurement area	Approx. $\phi 8$ mm, approx. $\phi 5$ mm (optional accessory) (*Optional $\phi 5$ mm mask does not conform to DIN 5033 Teil 7 and CIE No. 15.)
Repeatability	Standard deviation within $\Delta E^*ab$ 0.1 (when a white calibration plate is measured 30 times at 10-second intervals)
Display languages	English, Simplified Chinese, Japanese
Interface	USB2.0
Observer	10° Standard Observer
Illuminant	D65
Display data	Color difference, average (up to 10 times), Pass/fail judgment
Color different formula	$\Delta(L^*a^*b^*)$ , $\Delta(L^*C^*H^*)$ , $\Delta E^*ab$ (CIE 1976)
Data memory	Target data, Samples data(up to 1,000 in total)
Pass/fail item	$\Delta E^*ab$ , $\Delta(L^*a^*b^*)$ , $\Delta(L^*C^*H^*)$
Operation temperature/ humidity range	0 to 40°C, relative humidity 85% or less (at 35°C) with no condensation
Storage temperature/ humidity range	-20 to 40°C, relative humidity 85% or less (at 35°C) with no condensation
Power	4 AA-size alkaline dry batteries or nickel-metal-hydrate rechargeable batteries, USB bus power or special AC Adapter
Size (W x H x D)	66 x 158 x 85 mm
Weight	420 g (without batteries)

## PC system requirement

OS Windows<sup>®</sup> 7 Professional 32bit, 64bit  
Windows<sup>®</sup> 8 Pro 32bit, 64bit  
Windows<sup>®</sup> 8.1 Pro 32bit, 64bit  
Windows<sup>®</sup> 10 Pro 32bit, 64bit  
(English, Simplified Chinese, or Japanese)

- The hardware of the computer system to be used must meet or exceed the recommended system requirements for compatible OS being used.
- One USB2.0 port is necessary.

- The specifications and appearance shown herein are subject to change without notice.
- KONICA MINOLTA, the Konica Minolta logo and symbol mark, and "Giving Shape to ideas" are registered trademarks or trademarks of KONICA MINOLTA, INC.
- Other company names and product names used herein are trademarks or registered trademarks of their respective companies.



### SAFETY PRECAUTIONS

For correct use and for your safety, be sure to read the instruction manual before using the instrument.

- Always connect the instrument to the specified power supply voltage. Improper connection may cause a fire or electric shock.
- Be sure to use the specified batteries. Using improper batteries may cause a fire or electric shock.

KONICA MINOLTA, INC.  
Konica Minolta Sensing Americas, Inc.  
Konica Minolta Sensing Europe B.V.

Osaka, Japan  
New Jersey, U.S.A.  
European Headquarter /BENELUX  
German Office  
French Office  
UK Office  
Italian Office  
Swiss Office  
Nordic Office  
Polish Office  
Turkish Office  
SE Sales Division  
Beijing Office  
Guangzhou Office  
Chongqing Office  
Qingdao Office  
Wuhan Office

Konica Minolta (CHINA) Investment Ltd.

Konica Minolta Sensing Singapore Pte Ltd.  
Konica Minolta Sensing Korea Co., Ltd.

Addresses and telephone/fax numbers are subject to change without notice. For the latest contact information, please refer to the KONICA MINOLTA Worldwide Offices web page :

Phone : 888-473-2656 (in USA), 201-236-4300 (outside USA)  
Nieuwegein, Netherlands Phone : +31 (0) 30 248-1193  
München, Germany Phone : +49 (0) 89 4357 156 0  
Roissy CDG, France Phone : +33 (0) 1 80 11 10 70  
Warrington, United Kingdom Phone : +44 (0) 1925 467300  
Cinisello Balsamo, Italy Phone : +39 02849488.00  
Dietikon, Switzerland Phone : +41 (0) 43 322-9800  
Västra Frölunda, Sweden Phone : +46 (0) 31 7099464  
Wroclaw, Poland Phone : +48 (0) 71 73452-11  
Istanbul, Turkey Phone : +90 (0) 216-528 56 56  
Shanghai, China Phone : +86- (0)21-5489 0202  
Beijing, China Phone : +86- (0)10-8522 1551  
Guangdong, China Phone : +86- (0)20-3826 4220  
Chongqing, China Phone : +86- (0)23-6773 4988  
Shandong, China Phone : +86- (0)532-8079 1871  
Hubei, China Phone : +86- (0)27-8544 9942  
Singapore Phone : +65 6563-5533  
Goyang-si, Korea Phone : +82 (0) 2-523-9726

Fax : 201-785-2482  
Fax : +31 (0) 30 24 81 211  
Fax : +49 (0) 89 4357 156 99  
Fax : +33 (0) 1 80 11 10 82  
Fax : +44 (0) 1925 711143  
Fax : +39 02849488.30  
Fax : +41 (0) 43 322-9809  
Fax : +48 (0) 71 734 52 10  
Fax : +90 (0) 212-253 49 69  
Fax : +86- (0)21-5489 0005  
Fax : +86- (0)20-3826 4223  
Fax : +86- (0)23-6773 4799  
Fax : +86- (0)532-8079 1873  
Fax : +86- (0)27-8544 9991  
Fax : +65 6560-9721  
Fax : +82 (0) 31-995-6511

<https://konicaminolta.com/instruments/network>